

# TROFAZNI KAPILARNI TERERMOSTATI MMG

## 16A/400V

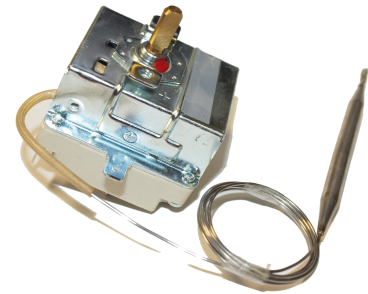

### Specification:

After reaching the pre-set temperature, the thermostat automatically disconnects the electric circuit, in case of temperature drop it connects again and thus continuously keeps the medium temperature by on/off switching. These thermostats are used particularly for washing machines, industrial kitchen cookers, ovens etc. It is suitable for temperature control of liquid, gas and solid substances.

Technical parameters	
Switching range:	16 A, 400 V
Life-time:	100.000 switch ons
Touch protection:	I. (earthed)
IP protection:	IP00
Connection:	A 6,3 terminal clip
Max. surrounding temperature:	150°C
Max.temperature of sensor surrounding:	Upper switching value + 15%
Relative air humidity:	30-80%
Storing temperature:	5-50°C
Installation:	inner
Use position:	optional
Weight:	80 g

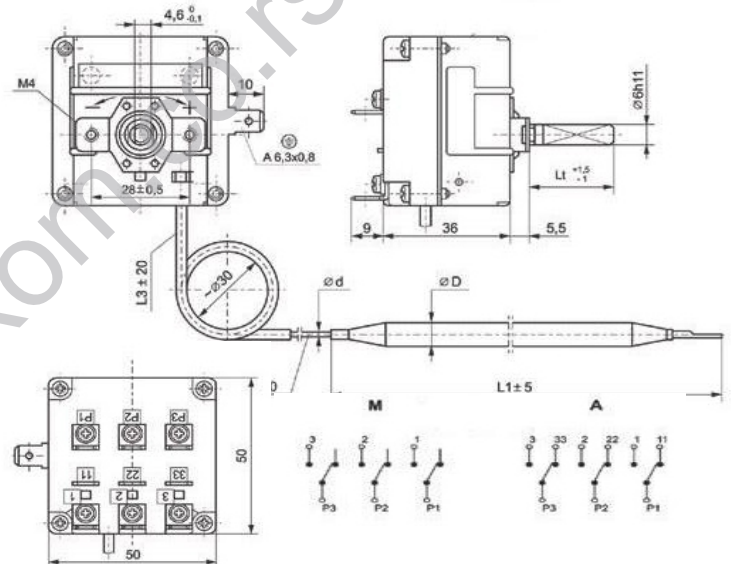

Type:	Regulatory range: (°C)	Switching temperature difference (°C)	Sensor diameter (mm)	Sensor length (mm)	Capillary length (mm)
5270-0-101-1	50-280	10	4	168	420
5270-0-101-4	50-300	10	4	168	1500
5270-0-101-9	50-280	10	6	168	920
5270-0-104-4	50-190	10	6	95	600
5270-0-104-8	50-190	10	6	95	920
5270-0-105-0	50-220	10	6	95	920
5270-0-113-4	20-110	4	6	165	920
5270-0-114-2	20-80	4	8	88	920
	25-85				
	30-90				
5270-0-118-4	50-230	12	3	276	920
5270-0-131-1	50-300	10	4	168	920